



Plastic – light pallet (CS 1)
1200 x 800 x 150 mm

Doc. Type	T S T		
Doc. Num.	N 098 02.03		
Doc. Part	001	Doc. Ver.	00
Date:	2017-10-12	Page 1 of 6	

Content

Changes	2
Previous Editions	2
1 SCOPE	2
2 REFERENCES	2
3 APPLICATION	2
4 SPECIFICATION	3
4.1 Dimensions	4
4.2 Bending data	5
4.2.1 Test precondition	5
5 IDENTIFICATION	6
5.1 Continental Logo	6
5.2 SAP - Packaging-part-number	6
5.3 Positioning of the printing of the left pallet skid	6

Weitergabe sowie Vervielfältigung dieses Dokuments, Verwertung und Mitteilung seines Inhalts sind verboten, soweit nicht ausdrücklich gestattet. Zuwiderhandlungen verpflichten zu Schadenersatz. Alle Rechte für den Fall der Patent-, Gebrauchsmuster- oder Geschmacksmustereintragung vorbehalten.

The reproduction, distribution and utilization of this document as well as the communication of its contents to others without express authorization is prohibited. Offenders will be held liable for the payment of damages. All rights reserved in the event of the grant of a patent, utility model or design.

No guarantee can be given in respect of the translation. In all cases the latest German-Language version of this standard shall be taken as authoritative.

MITTEILUNG NR.
NOTE NO.

ERSTELLT DURCH
CREATED BY

GENEHMIGT VON
APPROVED BY

FREIGEgeben VON
RELEASED BY

© Continental AG. 2017

ZPA-17140010

SCMA CTP
Team

SCMA CTP
Katja Brüne

QPS
U.Czerwon

Changes

No - new release

Previous Editions

No - new release

1 SCOPE

This standard applies to all companies of Continental Automotive Divisions, their plants and departments.

2 REFERENCES

TST N 00155.50-000	Design standard brand „Continental“ on products created in the production process
TST N 09801.09-000	Plastic pallet test specification
DIN 16742 TG8	Plastics moulded parts – Tolerances and acceptance conditions
ISO 8611	Pallets for materials handling -Flat pallets - Part 1: Test methods (ISO 8611-1:2011); German version EN ISO 8611-1:2012

3 APPLICATION

Plastic – pallet for general use

4 SPECIFICATION

Nominal dimensions	1200 x 800 x 150 mm
External dimensions	1209 x 815 x 172 mm
Base frame construction	3 skid - pallet Vertical entry and bottom openings for lifting devices: 100 mm on front side
Underrideability	4-way - entry pallet
Top desk construction	Broken surface (open work)
Skid design	Skids with plastic sheets (5 mm thick, grey, new material), reinforced and welded
Locking	Outboard, side at the deck, circumferentially interrupted, height 22mm, material thickness 5 mm
Color	RAL 7012, basalt grey (pallet- body) RAL 7042, traffic grey (skid plates)
Material	HD-PE, re-granulate
Tare - weight	ca. 14,5 kg
Max. payload, static load	5.000 kg *
Max. payload, dynamic load	1.000 kg *
Max. payload, in high rack	800 kg * (Two point edition)

* Conditions: Evenly loaded/ large-area loading

Identification with Continental logo RAL 1028 melon yellow, respectively on the long sides, left pallet skid, according to TST N 00155.50-000, permanently marked

Identification with SAP-number **98-6000-0191-5-00**, RAL 1028 melon yellow, respectively on the long sides, left pallet skid below the Continental logo, permanently marked

Two crescent-shaped openings on the deck, e.g. for the insertion of RFID tags

4.1 Dimensions

Dimensions in millimeter [mm]
Dimensions without tolerances, according to DIN 16742 TG8

Long side:

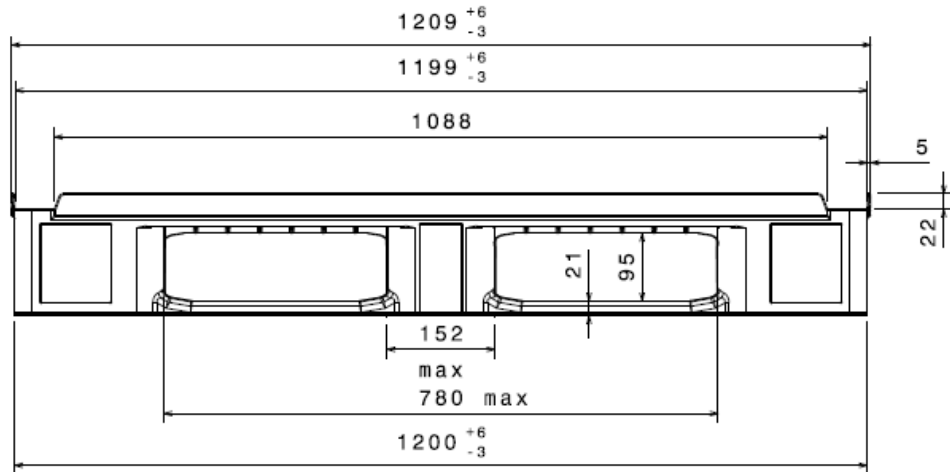

Front side:

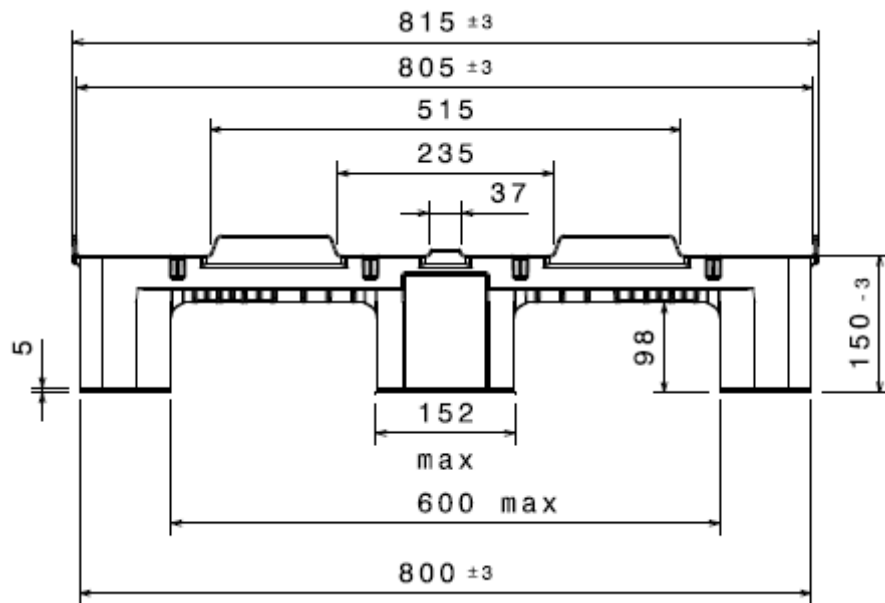

Cover :

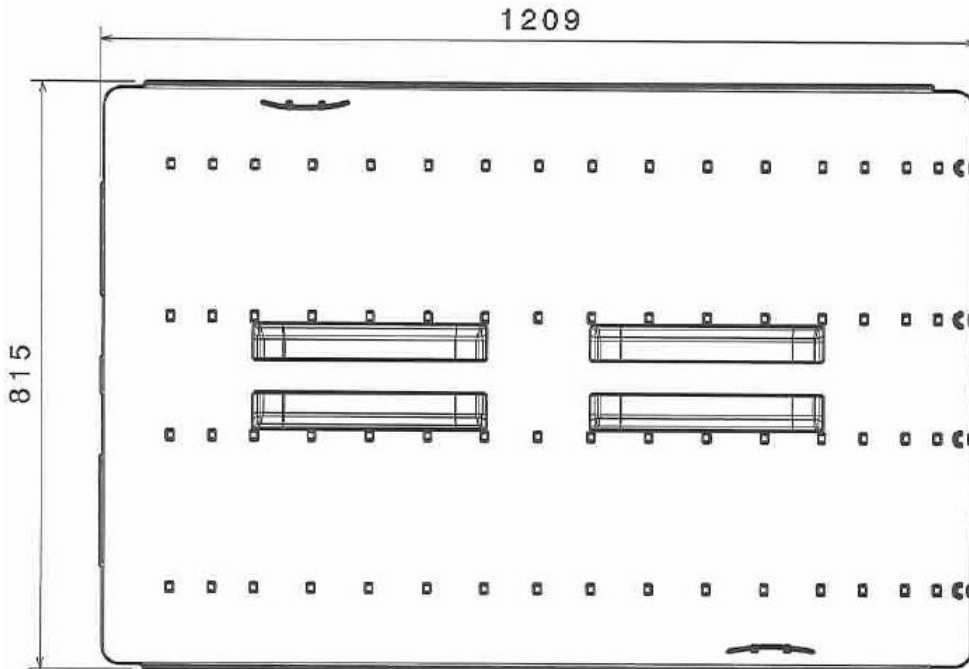

4.2 Bending data

The deflection of a plastic pallet under load is normal. However, they must not be exceeded 21 mm (ISO 8611-2)

4.2.1 Test precondition

Palette / Pallet:	CS-1
Ausführung / Construction :	Kufen verschweißt / skids welded
Material / Material :	PE Extruder
Gewicht / Weight :	14,5 kg
Belastungsart / Load type :	Flächenlast / distributed load
Aufbau / Configuration :	Granulatsäcke + Gewichtsplatte / Granulat sacks + steal weight plates
Prüfgewicht / Check weight :	800 kg
Prüfdauer / Duration of test :	100 Stunden / hours

5 IDENTIFICATION

5.1 Continental Logo



Color: RAL 1028 melon yellow
Logo print: according to TST N 00155.50

5.2 SAP - Packaging-part-number

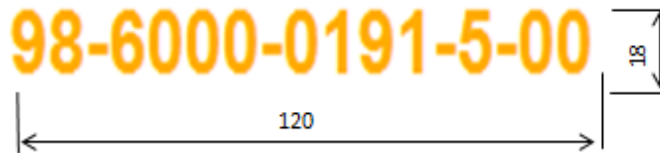

Color: RAL 1028 melon yellow
Font: Arial

5.3 Positioning of the printing of the left pallet skid

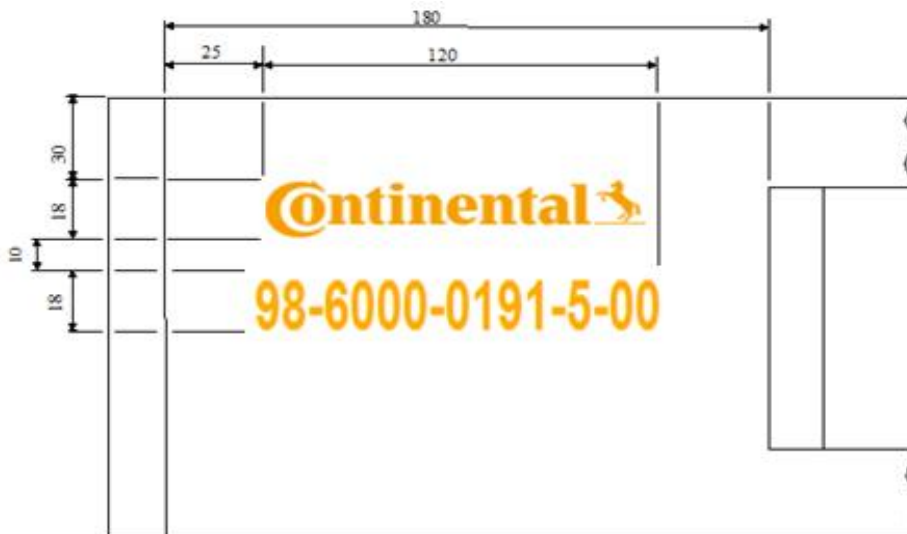

Position: Long side, left pallet skid, both sides